



Gas Solenoid Valves /Electromagnetic Valve

Suitable for installation in Intrinsically Safe Areas

Manufactured to ISOEN 161 Class A Group 2

Explosion Proof Mark : MI /IIT4

Explosion Proof Certificate GYC97420

IP65 Rated

230 volts 50 Htz



Order Code	BSP	mm	Solenoid Operation	Working Pressure	Switch Time	m3h	Type
GSV200	1/2"	15mm	Direct	0.07 ~ 1.6	0.5sec	1.70	Normally Closed
GSV300	3/4"	20mm	Direct	0.07 ~ 1.6	0.5sec	5.10	Normally Closed
GSV400	1"	25mm	Direct	0.07 ~ 1.6	0.5sec	5.35	Normally Closed
GSV500	1.1/4"	30mm	Pilot	0.1~1.6	0.33 sec	20.0	Normally Closed
GSV600	1.1/2"	40mm	Pilot	0.1~1.6	0.33 sec	25.0	Normally Closed
GSV700	2"	50mm	Pilot	0.1~1.6	0.33 sec	43.0	Normally Closed

Solenoid Valve Switch Types

DIRECT-ACTING 2-WAY VALVES

Two-way valves are shut-off valves with one inlet port and one outlet port. In the de-energized condition, the core spring, assisted by the fluid pressure, holds the valve seal on the valve seat to shut off the flow. When energized, the core and seal are pulled into the solenoid coil and the valve opens. The electro-magnetic force is greater than the combined spring force and the static and dynamic pressure forces of the medium.

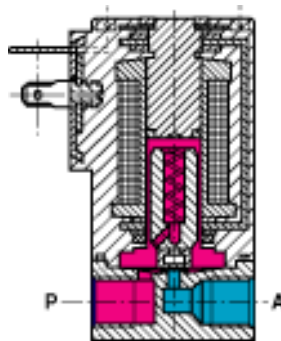

www.meters.co.uk



Authorised User No. 00475

meters uk Ltd

Utility Meter Manufacturers

Whitegate, White Lund Trading Estate, Lancaster,
Lancashire, England, LA3 3BT

Tel +44 1524 555929 Fax + 44 1524 847009

e mail sales@meters.co.uk

web www.meters.co.uk



Certificate No. 2030



INTERNALLY PILOTED 2-WAY VALVES

Internally piloted solenoid valves are fitted with either a 2- or 3-way pilot solenoid valve. A diaphragm or a piston provides the seal for the main valve seat. The operation of such a valve is indicated. When the pilot valve is closed, the fluid pressure builds up on both sides of the diaphragm via a bleed orifice. As long as there is a pressure differential between the inlet and outlet ports, a shut-off force is available by virtue of the larger effective area on the top of the diaphragm. When the pilot valve is opened, the pressure is relieved from the upper side of the diaphragm. The greater effective net pressure force from below now raises the diaphragm and opens the valve. In general, internally piloted valves require a minimum pressure differential to ensure satisfactory opening and closing.

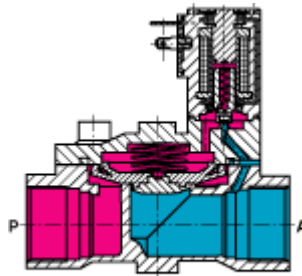

Model	A	B	C	D	E	F	J	K	SW	Normal close		
										H	Ha	a
0927200	G1/2"	14	55	49	35	22.5	45	43	27	98	116	34
0927300	G3/4"	16	85	67	45	30	60	60	41	115	133	
0927400	G1"											
0927500	G1¼"	18	132	93.5	32.5	48.1	-	96	58	145.5	161.5	48
0927600	G1½"											
0927700	G2"											

Direct

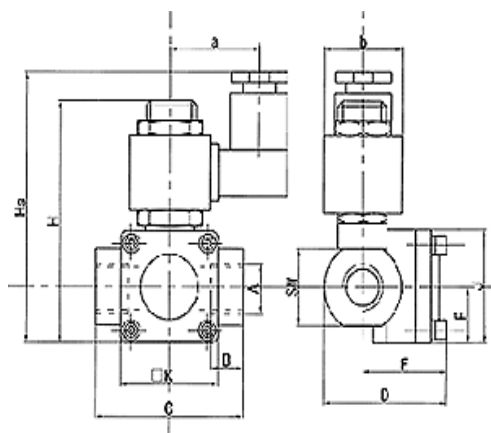

Pilot

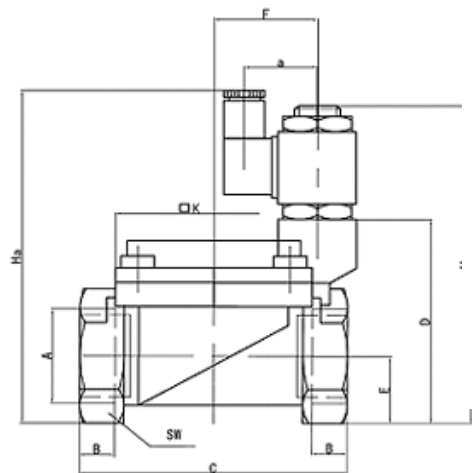

www.meters.co.uk



Authorised User No. 00475



Certificate No. 2030